





## 17, Lansdowne Street, Cheshire, SK10 2QZ

This well-presented 2-bedroom mid-terrace property offers convenience, comfort, and charm — just a short walk to Macclesfield town centre, the train station, and excellent transport links. Located in a quiet, residential area, this home is ideal for single professionals or couples looking for easy access to local amenities, shops, cafes, and transport connections.

### Key Features:

- Spacious Living Area
- Modern Fitted Kitchen
- Recently Refurbished Bathroom
- Two Generous Bedrooms
- Private Yard to the Rear
- On-Street Parking Available

The property is furnished and available start of August. Tax Band A. EPC rating D. A £100.00 Holding Deposit must be paid within 24 hours of an offer being accepted. A Pet may be considered for an additional £50.00 per month.

To arrange a viewing please call Holden and Prescott, 01625 422 244.

### Location:

SK10 2QZ, Lansdowne Street.

SK10 2QZ, Lansdowne Street.

**Viewing: By appointment with Holden and Prescott 01625 422244**

HOLDEN & PRESCOTT

# HOLDEN & PRESCOTT

## **Lounge**

12'7" x 10'7" m

## **Dining Kitchen**

10'11" x 10'7"

## **Bedroom 1**

12'7" x 10'7"

## **Bedroom 2**

8'7" x 8'0"

## **Bathroom**

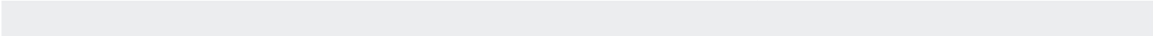

**£900 PCM**

HOLDEN & PRESCOTT

**Ground Floor**

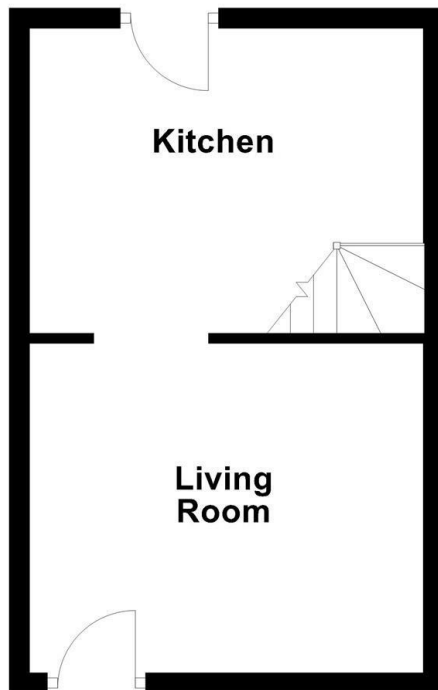

**First Floor**

